

# TRS SERIES Commercial Lighting

TRS-10-20W-MCTP-36D-WH

TRS-10-20W-MCTP-36D-BK

BUILDER SERIES TRACK HEADS WITH EXT. DRIVERS, POWER AND CCT ADJUSTABLE

**MCTP** Multi Color Temperature & Multi Power/Wattage (Selectable)

Customer Name: \_\_\_\_\_

Project Name: \_\_\_\_\_

Note: \_\_\_\_\_

Type: \_\_\_\_\_

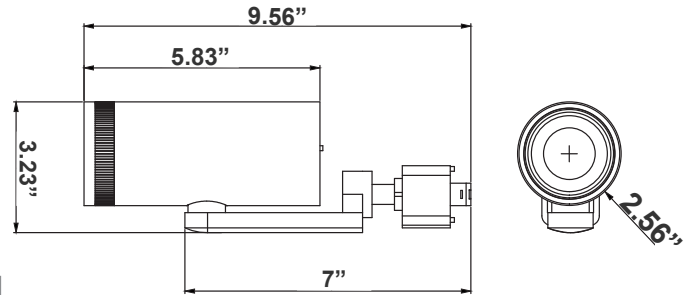

9.56" (W) x 3.23" (H) x 2.56" (D)

The Builder Series Track Heads: the ultimate versatile and efficient lighting solution designed to meet the diverse needs of modern lighting projects. With an array of adjustable features, elegant finishes, and superior performance, the Builder Series Track Heads are perfect for any space requiring high-quality, adaptable lighting.

## Features

- High Light Transmittance, Anti-UV and Fire Resistant PC Lens
- 7-Year Warranty
- Die-Cast Aluminum With Powder Coat Finish
- Multi CCT and Power (Switches are on back of the fixture)

## Technical Specifications

### Electrical:

- Voltage: 120-277VAC 60Hz
- Wattage: 10W/15W/20W
- Power Factor: >0.95
- Efficacy: 90 LPW

### Mechanical:

- Die-Cast Aluminum, Powder Coated Finish
- 90° vertical adjustment, 358° rotation
- Lens: Clear Tempered Glass Lens Secured To Housing By Threaded Lens Cap
- Effortlessly installed into H-Type single-circuit track
- Operating Temperature: -4°F to 104°F
- 7-Year Warranty

### Lighting:

- Dimming: Triac and ELV dimmable down to 10%. Flicker-Free Dimming. For Full List Of Dimmers Refer To The Dimmer Compatibility List
- Multi CCT (Switches Are On The Driver Box)
- Total Lumens: 1800LM
- Color Temperatures: 2700K/3000K/3500K/4000K/5000K
- Color Rendering Index: CRI ≥ 90
- Beam Angle: Adjustable from 36°
- Rated Life: 70,000 Hrs

### Applications:

- Retail Stores: Enhance product displays with adjustable lighting that draws attention and creates a welcoming shopping experience.
- Galleries and Museums: Showcase artwork with precision lighting that can be easily adjusted to suit different exhibits.
- Commercial Spaces: Provide flexible lighting solutions that can adapt to changing needs and layouts.



**Photometrics:** TRS-10-20W-MCTP-36D

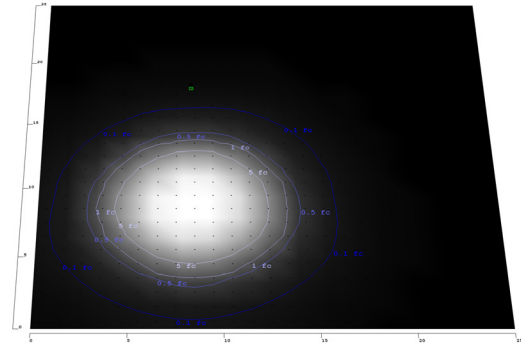
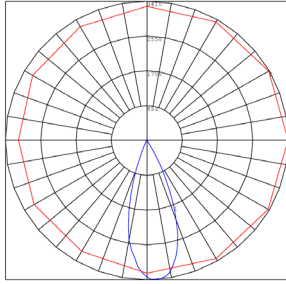

Area 25'x 25' Mounting Height: 9'

**Other Views:**



Side View



Lens View



Side View



Lens View

**Performance Table:** TRS-10-20W-MCTP-36D

MODEL NO.	Wattage	Voltage	Lumens	Color Temp.	LPW
TRS-10-20W-MCTP-36D-WH	10W	120~277V	900LM	3000K	90
TRS-10-20W-MCTP-36D-BK	15W		1350LM	3500K	
	20W		1800LM	4000K	

**Sample Ordering**

**Model Wattage. Wattage. Color TempBeam Angle Housing**

TRS - 10 - 20W - MCTP - 36D -

BK = Black  
WH = White

**Accessories:**

- Blank = No Option For Accessories
- TRS-H-J-WH = H-Type To J-Type Connector Head Converter, White
- TRS-H-J-BK = H-Type To J-Type Connector Head Converter, Black
- TR-2FT-BK = 2Ft 3-Wire Track, Black
- IR-2FT-WH = 2Ft 3-Wire Track, White
- IR-4FT-BK = 4Ft 3-Wire Track, Black
- TR-4FT-WH = 4Ft 3-Wire Track, White
- TR-6FT-BK = 6Ft 3-Wire Track, Black
- IR-6FT-WH = 6Ft 3-Wire Track, White
- TR-8FT-BK = 8Ft 3-Wire Track, Black
- TR-8FT-WH = 8Ft 3-Wire Track, White
- IR-LE-BK = 3-Wire Track Live End, Black
- IR-LE-WH = 3-Wire Track Live End, White
- IR-MC-BK = 3-Wire Track Mini Connector, Black
- IR-MC-WH = 3-Wire Track Mini Connector, White
- IR-SC-BK = 3-Wire Track Straight Connector, Black
- TR-SC-WH = 3-Wire Track Straight Connector, White
- TR-LC-BK = 3-Wire Track L Connector, Black
- TR-LC-WH = 3-Wire Track L Connector, White

**Accessories:**

- Blank = No Option For Accessories
- TR-TC-BK = 3-Wire Track T Connector, Black
- TR-TC-WH = 3-Wire Track T Connector, White
- TR-XC-BK = 3-Wire Track X Connector, Black
- TR-XC-WH = 3-Wire Track X Connector, White
- TR-FLEXC-BK = 3-Wire Track Flex Connector, Black
- IR-FLEXC-WH = 3-Wire Track Flex Connector, White
- TR-FC-BK = 3-Wire Track Floating Canopy, Black
- TR-FC-WH = 3-Wire Track Floating Canopy, White
- TR-MONC-BK = 3-Wire Track Mono Canopy, Black
- IR-MONC-WH = 3-Wire Track Mono Canopy, White
- IR-JBEF-BK = 3-Wire Track J-Box End Feed Kit, Black
- TR-JBEF-WH = 3-Wire Track J-Box End Feed Kit, White
- TR-CCON-BK = 3-Wire Track Conduit Connector, Black
- TR-CCON-WH = 3-Wire Track Conduit Connector, White
- TR-EC-BK = 3-Wire Track End Cap, Black
- TR-EC-WH = 3-Wire Track End Cap, White
- TR-EXTCON-BK = 3-Wire Track To Track Extension Connector, Black
- TR-EXTCON-WH = 3-Wire Track To Track Extension Connector, White



## Accessories:

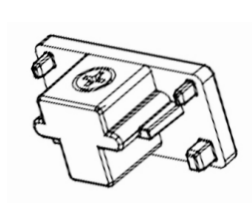

End Cap  
TR-EC-BK  
TR-EC-WH

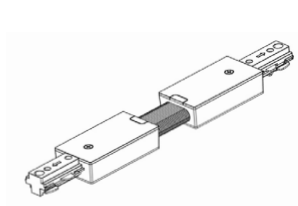

Flexible Connector  
TR-FLEXC-BK  
TR-FLEXC-WH

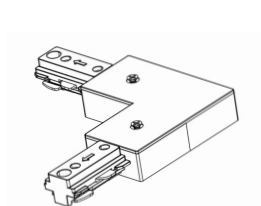

L Connector  
TR-LC-BK  
TR-LC-WH

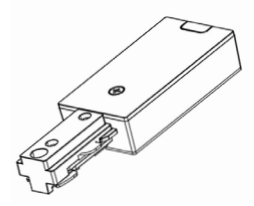

Live End Connector  
TR-LE-BK  
TR-LE-WH

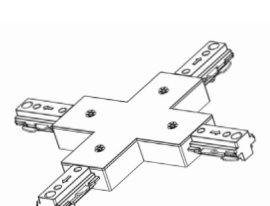

X Connector  
TR-XC-BK  
TR-XC-WH

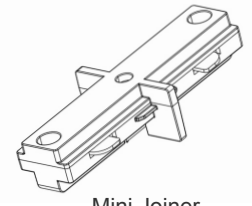

Mini Joiner  
TR-MC-BK  
TR-MC-WH



Monopoint Canopy  
TR-MONC-BK  
TR-MONC-WH

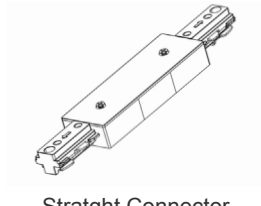

Straight Connector  
TR-SC-BK  
TR-SC-WH

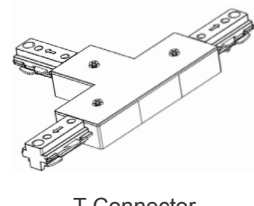

T Connector  
TR-TC-BK  
TR-TC-WH



Track Floating  
TR-FC-BK  
TR-FC-WH

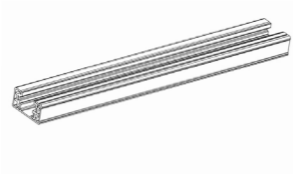

Track  
TR-2FT-BK  
TR-2FT-WH  
TR-4FT-BK  
TR-4FT-WH  
TR-6FT-BK  
TR-6FT-WH  
TR-8FT-BK  
TR-8FT-WH

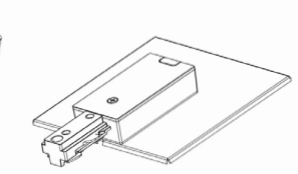

3-WIRE Track J-BOX  
Eed Feed Kit  
TR-JBEF-BK  
TR-JBEF-WH

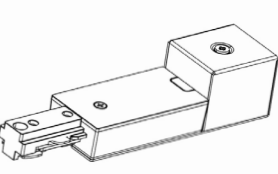

Live End Connector  
with Box  
TR-CCON-BK  
TR-CCON-WH

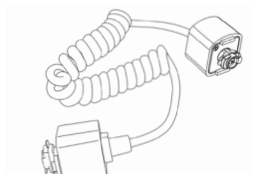

Track to Track Extension  
Connector  
TR-EXTCON-BK  
TR-EXTCON-WH

